

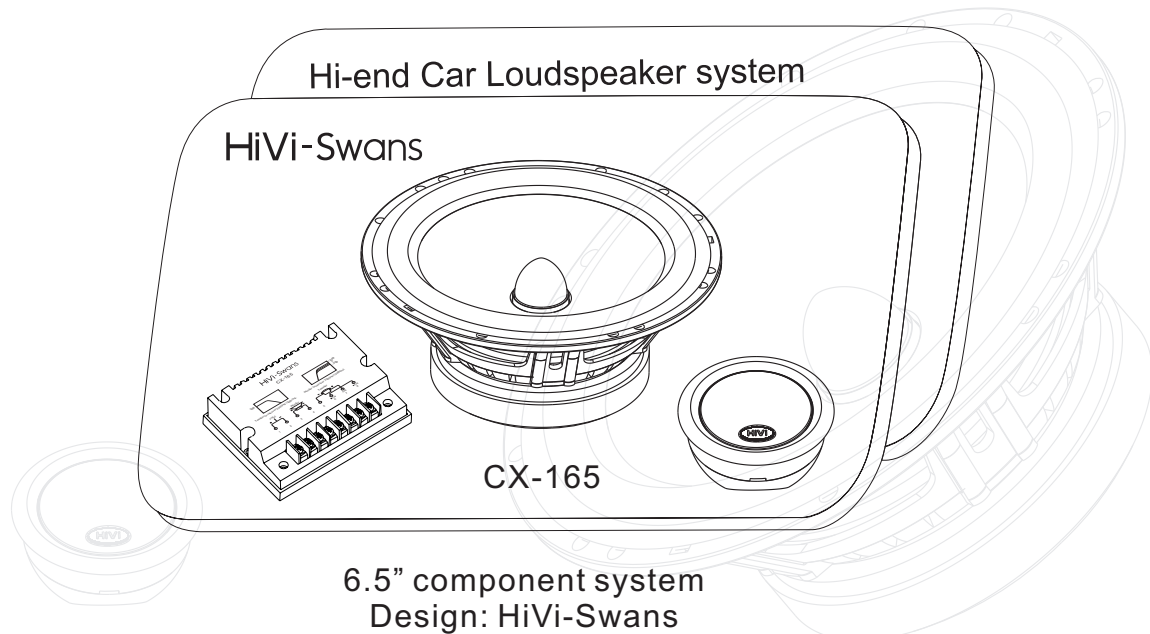

CX SERIES MANUAL



欢迎您选购惠威车用扬声器系统。为了便于您的安装及使用，我们编写本折页。请务必在安装使用之前，仔细阅读并清楚了解安装程序及注意事项，依据不同型号的扬声器系统，采用不同的安装方式。
虽然本折页说明了安装的方式，但是对于汽车拆装并没有作说明，假如您没有此方面的经验，请不要自行安装，您可以去有经验的汽车服务处进行咨询。

——请特别注意您的汽车处于熄火状态！

一、线路图：请按照以下线路图连接

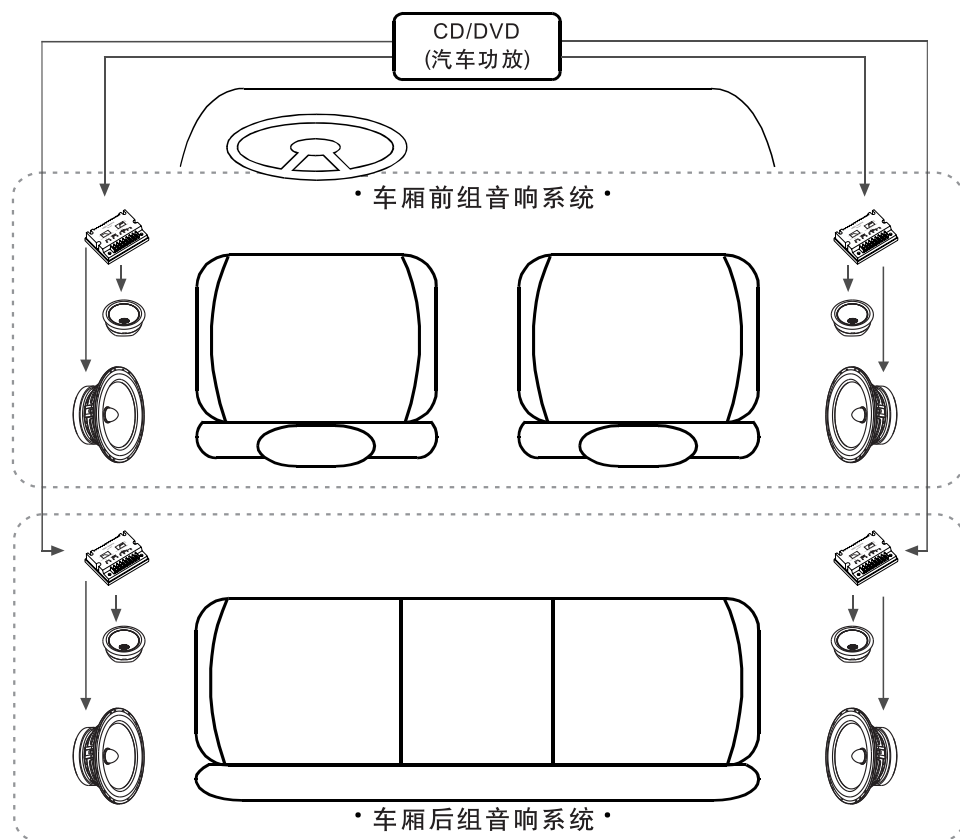

二、高音喇叭安装

安装方式一：如不想改变车结构，将高音安装在仪表盘前方或车门边，可以采用此方式。

- 1、取半圆形双面自粘EVA，去除一面保护纸后将它粘在高音喇叭的安装位(如图)。
 - 2、将自粘EVA的另一面保护纸去除，然后将喇叭粘在选定的位置。
 - 3、调整喇叭方向，以便达到理想的听音效果。
- 注:此种方式优点在于可以完全不对车进行改变；缺点是不能很牢固的固定高音。

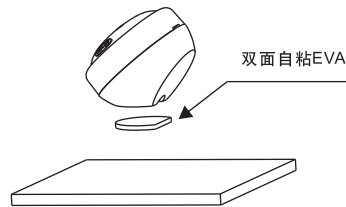

安装方式二：要想牢固地将高音安装在仪表盘前方或车门边，可以采用此种安装方式。

- 1、先用“一字”螺丝刀将高音喇叭的前盖打开。
 - 2、按图示将安装螺丝穿过后盖、安装板，将高音喇叭的后盖锁紧在选取的位置。
 - 3、将喇叭装入后盖内、压紧前盖。
 - 4、调整喇叭的方向，以便达到理想的听音效果。
- 注:此种方式需在车上锁螺丝，故在安装前须确定高音喇叭的安装位置。

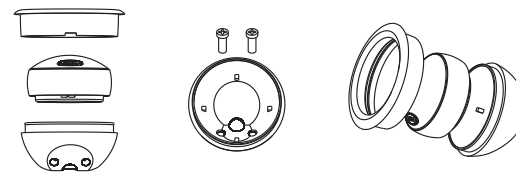

三、低音喇叭安装

- 1、依实际需要将密封垫片贴于喇叭的安装位。
- 2、将装饰网的网拆除，螺丝穿过装饰网塑料件及喇叭安装孔将喇叭锁紧。
- 3、当安装深度不够时，可以在喇叭的安装位加一垫圈以增加安装深度。
- 4、将网按图示装于喇叭上。

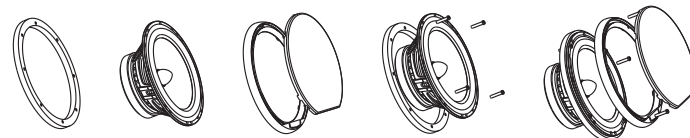

四、分频器安装：

- 1、在车门或其他你想安装的地方确定安装位置，以不影响其它部分为准，然后将分频器用螺丝固定在上面，如下图：

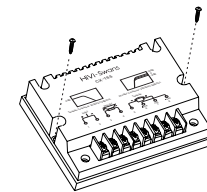

五、接线方法：

- 1、分频器与高音、低音连接示意图。

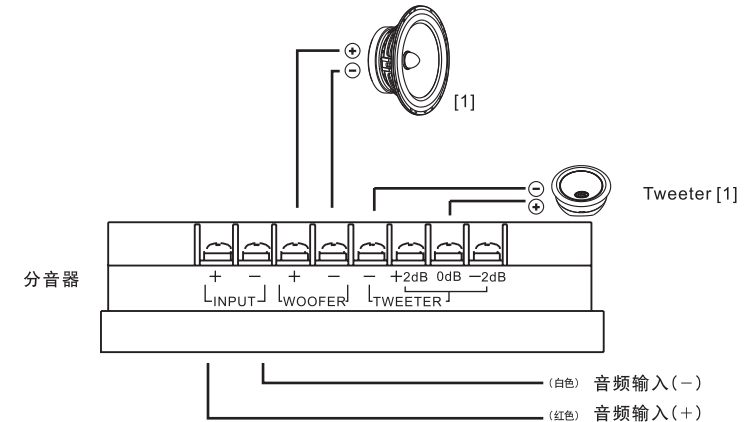

注：高音部分可以根据汽车内饰情况及个人喜好设定为+2dB、0dB、-2dB三种状态。

六、规格：

型 号	CX-165
中 低 音	CX6S
高 音	KX26T
灵 敏 度	88dB
频率响应	50Hz-20KHz
最大功率	100W
额定功率	50W
额定阻抗	4Ω
安装尺寸	Φ157mm
开孔尺寸	Φ148.5mm
安装深度	>68mm
网罩尺寸	Φ172X22mm
高通衰减斜率	12dB/Octave
低通衰减斜率	12dB/Octave

惠威车用扬声器系统
www.hivi.com



CX SERIES MANUAL

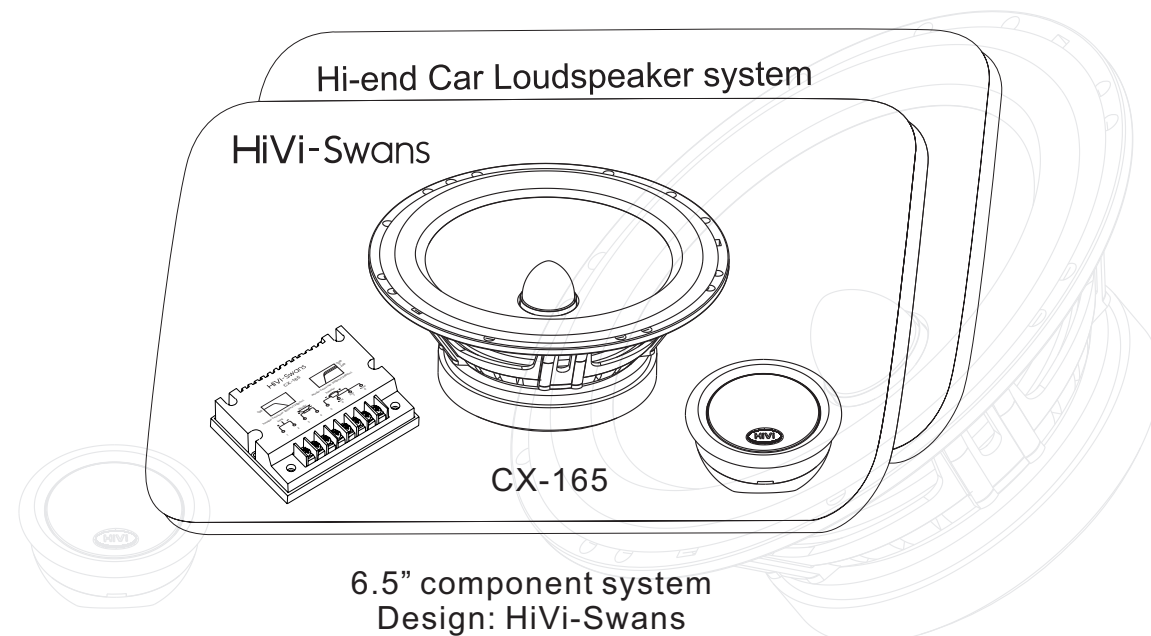

Thank you for your purchase of HiVi-Swans Car-Audio Speaker Systems. Please read the following installation and operation guidelines carefully to ensure many years enjoyment of car audio speaker system. All HiVi-Swans Speaker Systems products should be set-up and installed by authorized and licensed technicians.

Though this manual narrates the installation, it didn't show the remove of car. If you got no experience of this, please don't set up by yourself, you can inquire at the experienced car service office.

———— Please note your car is on flameout situation!

Circuit diagram Please connect according to the following circuit diagram

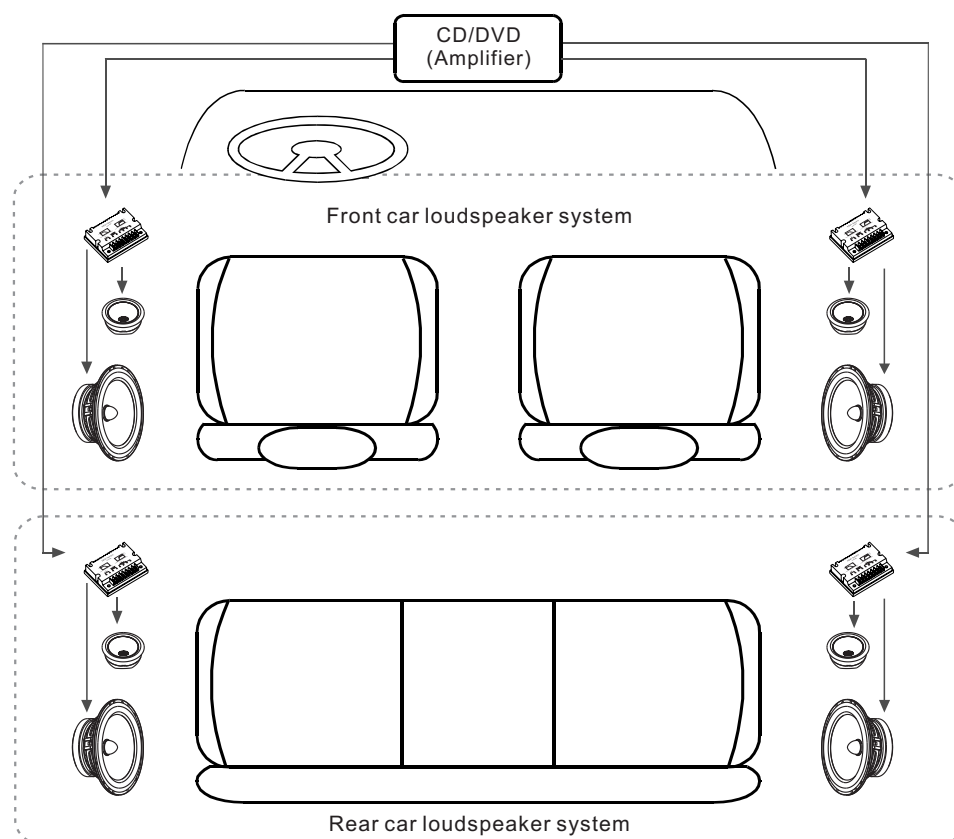

Installation of Tweeter

Option One: if you don't want to change the structure of car, and install the tweeter before steering wheel or beside the door of car, then you can use this mode.

- 1、Take semicircle double sides stick EVA, get rid of one side protecting paper and stick this on the place of installation of tweeter (as drawing).
- 2、Get rid of another protecting paper of EVA, then stick speaker at the fixed place.
- 3、Adjust the orientation of speaker so as to get the best sound quality.

Note: The merit of this kind of installation is that there's no need to change the car, the demerit is that it can't fix the tweeter well enough.

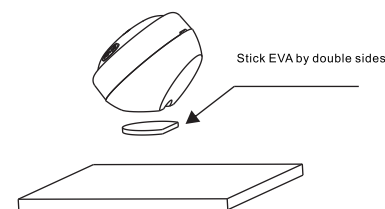

Option Two: If you want to fix the tweeter before the steering wheel or beside the door of car, then you can use this mode.

- 1、Use the "+" screwdriver open the front cover of tweeter.
- 2、Use the screw threading the back cover, installation plate, then fix the back cover of speaker on the selected place as drawing.
- 3、Put the speaker into the back cover, press the front cover.
- 4、Adjust the orientation of speaker so as to reach the best sound quality.

Note: This kind of installation needs to lock the screws on the car, so you have to fix the place of tweeter before installation.

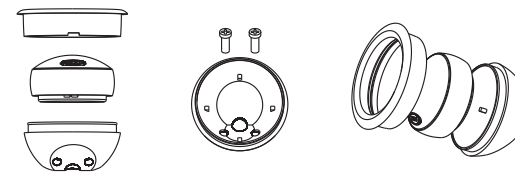

Installation of Woofer

- 1、According to the demand then stick the airproof mat on the place of installation.
- 2、According to the opening hole template then open the speaker hole and the snail installation hole in suitable place.
- 3、If the depth is not enough, can use some mats on the place of installation then can add some depth.
- 4、Install the net on the speaker as drawing.

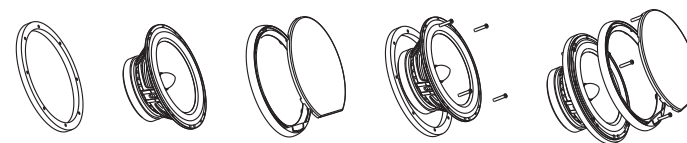

Installation of crossover:

- 1、Please make sure to check that the crossover will properly fit in the place you have selected for mounting. Once you are sure the position is ideal screw then crossover into position (See figure below).

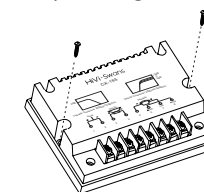

Connection:

- 1、The drawing of crossover and tweeter, woofer

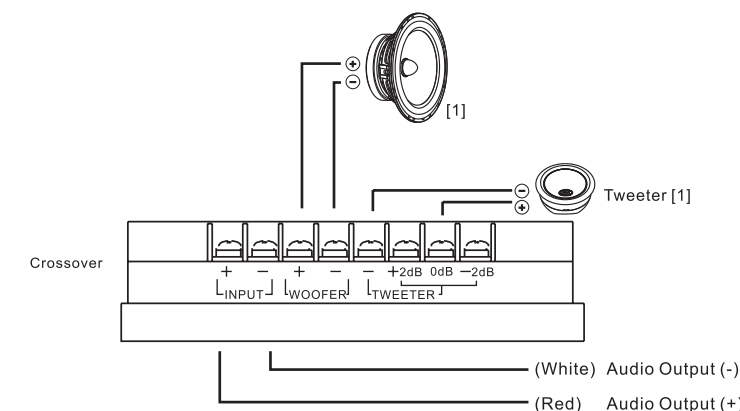

Notice: Three tweeter options of +2dB, 0dB, -2dB for you choose dependant on your car's internal acoustic environment and individual tastes.

Specifications:

Model	CX-165
Woofer	CX6S
Tweeter	KX26T
Sensitivity	88dB
Frequency Response	50Hz-20KHz
Max Power	100W
Power Handling	50W
Rating Impedance	4Ω
Installation Size	Φ157mm
Hole Size	Φ148.5mm
Installation Depth	>68mm
Net size	Φ172X22mm
High pass decay rate	12dB/Octave
Low pass decay rate	12dB/Octave

HI-END CAR LOUDSPEAKER SYSTEM
www.hivi.com